



Corbins Lane, HA2

£250,000

Upon entering the property, you are greeted by a central entrance hall, providing access to all rooms. A well-presented one-bedroom first-floor flat features an open-plan living space with double doors opening onto communal gardens, a fitted kitchen, a generously sized double bedroom, and a modern part-tiled bathroom with shower cubicle.

South Harrow Underground Station (Piccadilly Line) just a short walk away making it ideal for commuters heading into Central London. The area is well served, Aldi, Iceland, Asda, and several convenience stores are all within walking distance, making grocery shopping easy and accessible.

- First Floor Flat • Open plan living area/kitchen • One Spacious Bedroom •
- Communal Gardens • Allocated Parking • Purpose Built •

Approx Gross Internal Area
44 sq m / 470 sq ft

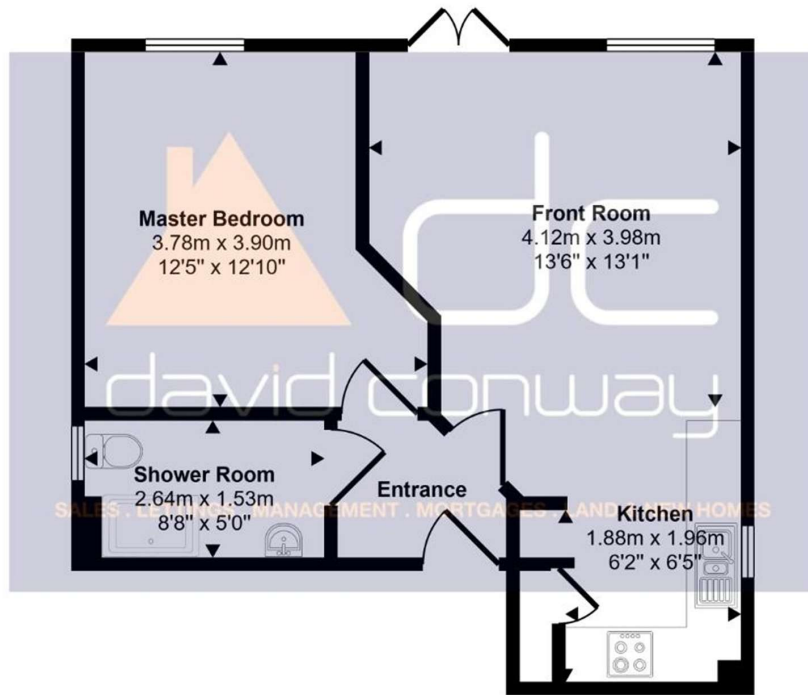

Floorplan

This floorplan is only for illustrative purposes and is not to scale. Measurements of rooms, doors, windows, and any items are approximate and no responsibility is taken for any error, omission or mis-statement. Icons of items such as bathroom suites are representations only and may not look like the real items. Made with Made Snappy 360.

David Conway
020 8422 5222

Energy Rating: C We aim to make our particulars both accurate and reliable. However they are not guaranteed; nor do they form part of an offer or contract. If you require clarification on any points then please contact us, especially if you're travelling some distance to view. Please note that appliances and heating systems have not been tested and therefore no warranties can be given as to their good working order.